

24' x 40' Classroom

The classic "portable" — now a modern classroom that fits in anywhere extra learning space is needed, permanently or temporarily.

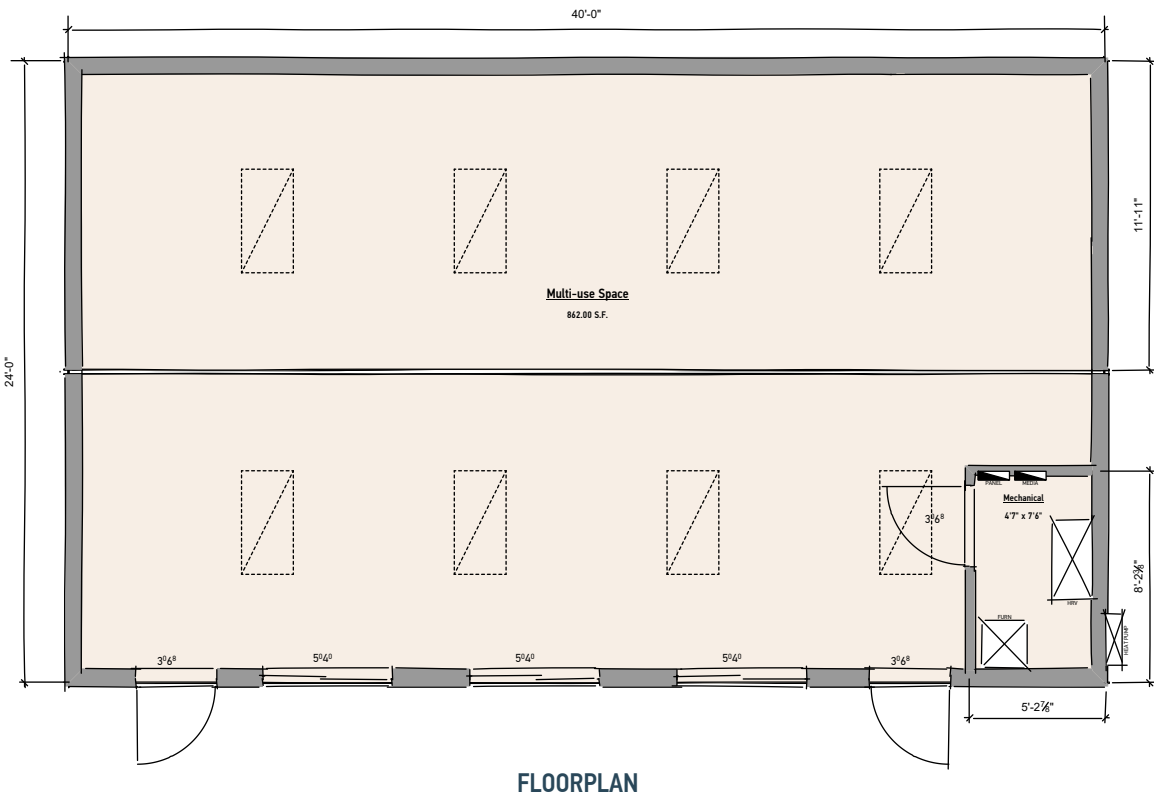

TOTAL AREA
960 SQ.FT.

OVERALL
24' x 40' x 11'7"

FOR MORE INFORMATION:

250-753-8550

sales@cipmodular.ca

1868 Fielding Road
Nanaimo, BC V9X 1T5



24' x 40' Classroom

General Specifications

EXTERIOR SIDING

7/8" Corrugated Tin; 2 tone: Charcoal & Copper; black trims

INTERIOR WALLS

Tape and filled 5/8" drywall, painted to suit

WINDOWS

5' x 4' Horizontal Slider; comes with insect screens; black exterior vinyl

EXTERIOR DOORS

Hollow metal insulated door, black; comes with passage set and deadbolt

PARTITION

Hollow core, prefinished white; comes with passage set

ROOF

EPDM rubber membrane; black; 100 PSI snow load; white termination bar

FLOOR

Vinyl sheet flooring

CEILING

Tape and filled 5/8" drywall, white

HEATING/COOLING

Electric up-flow furnace with 3 ton heat pump for cooling; c/w 500 cfm HRV; gas fired options available on request

LIGHTING

LED 2' x 4' flat panels; LED fixtures above doors; recessed pot lights in accessory rooms

ELECTRICAL

120/240 volt single phase; 200 amp service; duplex wall receptacles; tel/data conduits and patch panel installed; jacks and wiring not included

FIRE ALARM

Conduit and boxes included; wiring to be installed by client

PLUMBING

Optional

**BUILT IN ACCORDANCE
WITH CSA A277**



Intertek



Intertek

The above specifications are subject to change / customization.



COMMON AREA



COMMON AREA



COMMON AREA



COMMON AREA



COMMON AREA

